

Scent Machine: Smart 101

User Guide

Scan for
Digital Version



Always keep the machine and canister upright when it has oil in it, as it will spill if tilted.

Find the best location: The best spot is at least waist high, near an electrical outlet, in a spot that has plenty of air movement.

Place it or mount it: The machine can stand on its own (HINT: use the pad that the fragrance oil is wrapped in to stand the machine on to absorb vibration). To mount it, screw the metal mounting plate onto the wall and hang the machine on it, making sure both tabs catch.

Plug it in: It's okay if the pump runs without the oil installed - it won't hurt anything.

Set up the machine: The initial setup can be done before using the mobile app.

- Set the clock to the current time:
Press SET then UP/DOWN for hour (this is a 24-hour clock so 13:00 is 1:00PM). Press SET then UP/DOWN for minutes. Press SET then UP/DOWN for day of week-use UP to change, DOWN to move to next day. Press SET to confirm clock setting.
- There are 5 events so you can have the machine come on at different times, at different intensities, on different days. NOTE: An Event cannot go around midnight, so make sure every stop time is no later than 23:59.
- Set the first event:
Press MODE and set the time the machine comes on for the first event...
Press SET then UP/DOWN for start hour.
Press SET then UP/DOWN for start minute.
Press SET then UP/DOWN for days of the week for this event-use UP to change between fast blinking (on) to slow blinking (off) then DOWN to move to next day.
Press MODE then UP/DOWN to set the hour the machine stops for the days of this first event...
Press SET then UP/DOWN for stop minute.
Press MODE then UP/DOWN for the percentage of intensity. TIP: start at 20%.
Repeat this for the other four events or leave these blank if you just need one event.
To turn off an event, turn off (change to slow blinking) each day for that Event.
To reset everything back to factory default, press and hold Mode for 7 seconds.



Put in the oil: Keep canister upright at all times - it will spill!

- Open the oil hatch on the bottom of the machine and pull out the fragrance oil cartridge by the metal ring - **do not twist**, it pulls straight out.
- Unscrew the diffuser cap from the oil cartridge and pour the fragrance oil from the white bottle into the blue cartridge.
- Screw the black diffuser cap back on.
- Align the diffuser cap so that the two inlet/outlets are lined up facing the front of the machine.
- Push straight up until you feel it seat into the machine. This just pops in place - no turning.
- Close the oil hatch.

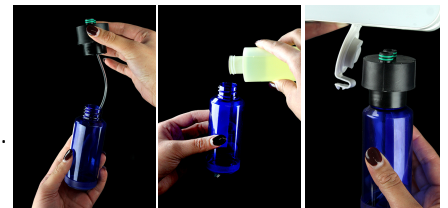

Adjust, maintain, and enjoy!

A full canister should last about a month when running the machine on medium setting (up to 30%) everyday for 12 hours. Start with a low intensity and go up from there. If you start with a high intensity and go lower, you may become temporarily nose blind to the scent at a lower setting. If the nozzle ever starts to whistle too much it may just be dirty - diffuse a small amount of alcohol instead of fragrance oil and it will self-clean.

Be sure to explore other fragrances over time. We can become nose blind to the same scent in our home over time because our brain starts to ignore it as a standard part of our environment. Check out our fragrance of the month, monthly newsletter, or call/email us for recommendations based on what you like.

Setting up the APP

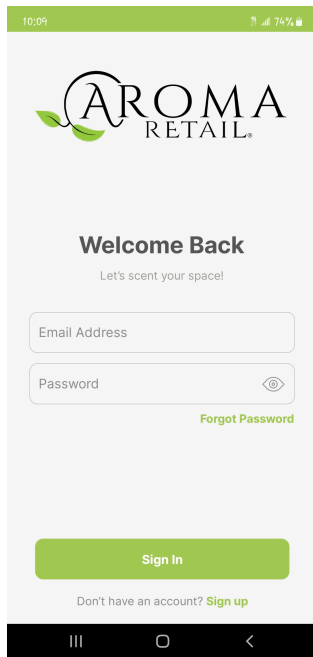

Your app sign-in is separate from your login on our website, but the email and password could be the same if you want it to be. Start with "Sign up" if you have not used this app yet.

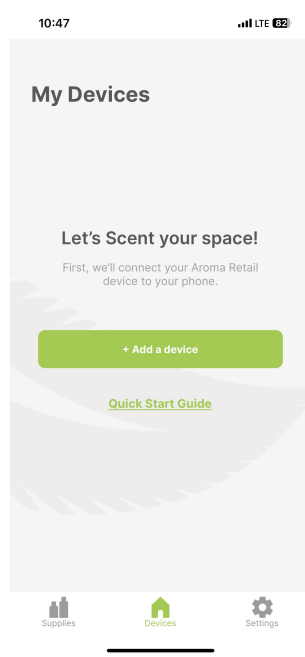

This is the Home Screen after Logging in. "Order Supplies" takes you to aromaretail.com to order fragrance oil. "Quick Start Guide" includes instructions for operating the machine from its controls.

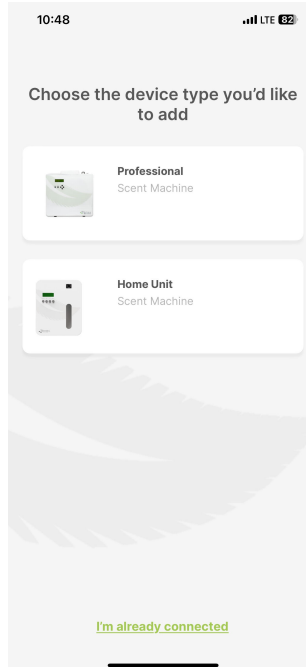

Select the type of machine.



Ensure your machine is plugged in and turned on.

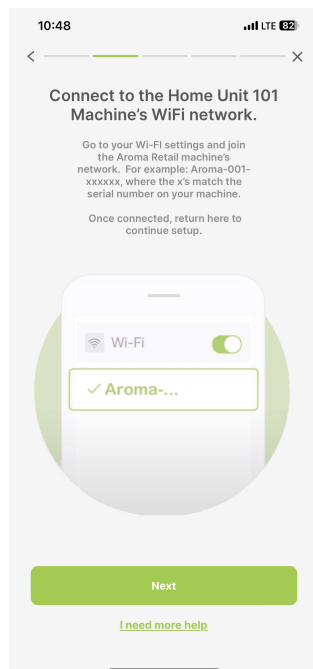

Swipe out of your app and go to your phone's WI-FI Settings to join your Machines network (AROMA-XX-XXXXXX) found on the back of your machine, then go back to the app and click "Next".

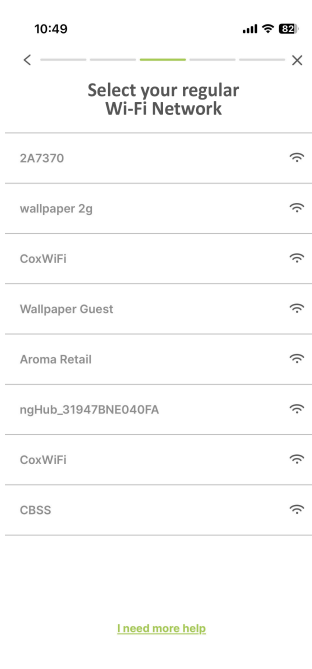

Select the WI-FI network the machine will be connecting to.

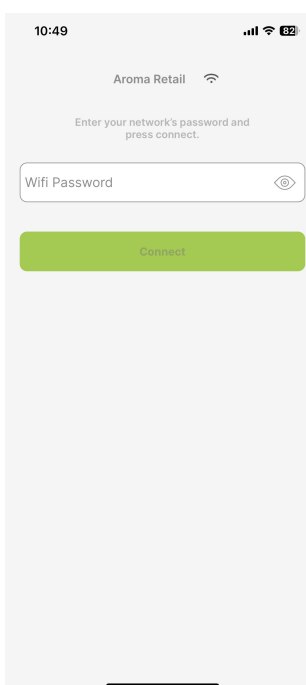

Enter your password for your network. It is important to ensure your password is correct for setup to work properly.

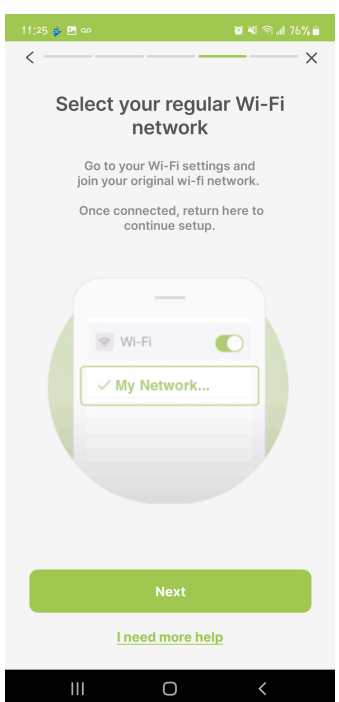

Connect your phone back to your own WI-FI network and click "Next".



Your machine is now Connected!
Click "Next"

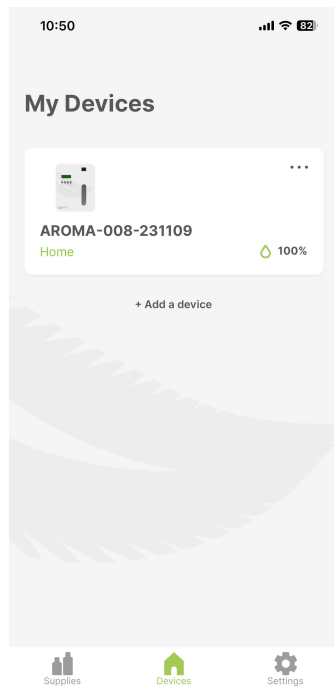

Your devices will now appear in your "My Devices". From here you can add a new device or edit the ones you have by clicking on the machine.

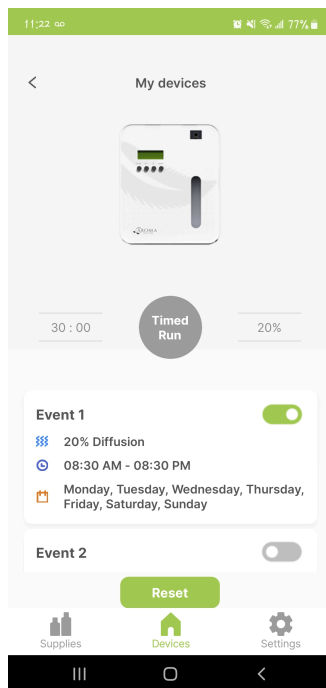

From here you can edit your machine's settings and events. Only one event is needed to run the machine, but multiple can be edited to account for different schedules. The toggles on this page turn the Events on/off.

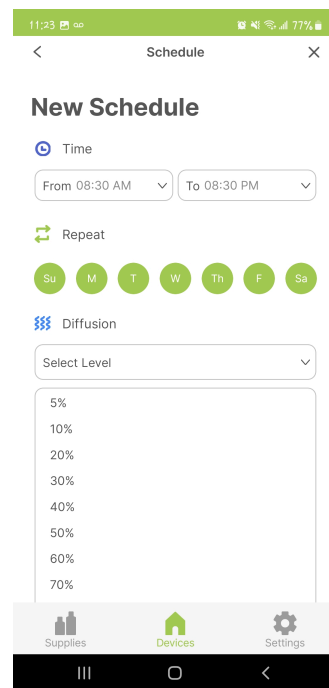

Clicking on a single event will bring you to a detailed edit page, where you can edit the time, day, and intensity of an event. Click "Save" when you're done.

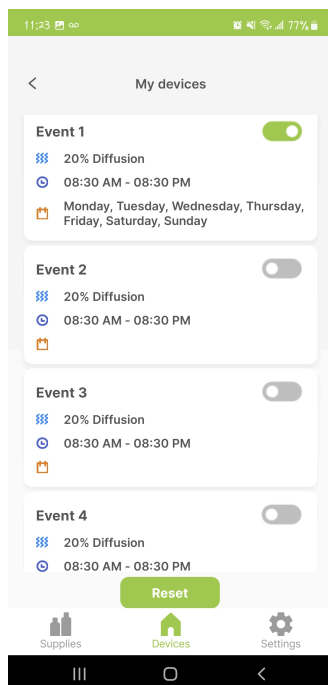

Your device can hold a maximum of 5 events and any of them can be quickly turned on or off through the toggle.

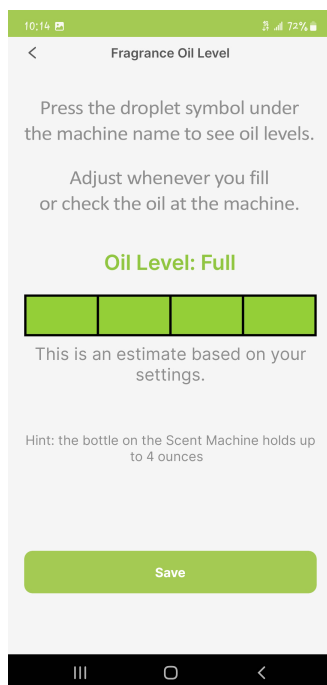

Press the droplet [🔹] under the machine name to get here. This is an estimate based on settings. Adjust whenever you fill or check the oil at the machine.

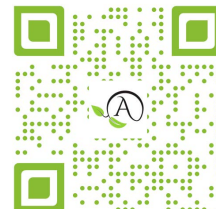
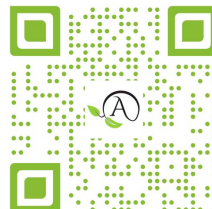

To move your machine to another device, you must delete the machine from the current device, and restart the machine by unplugging and plugging back in.

Free Standing / Direct To Space

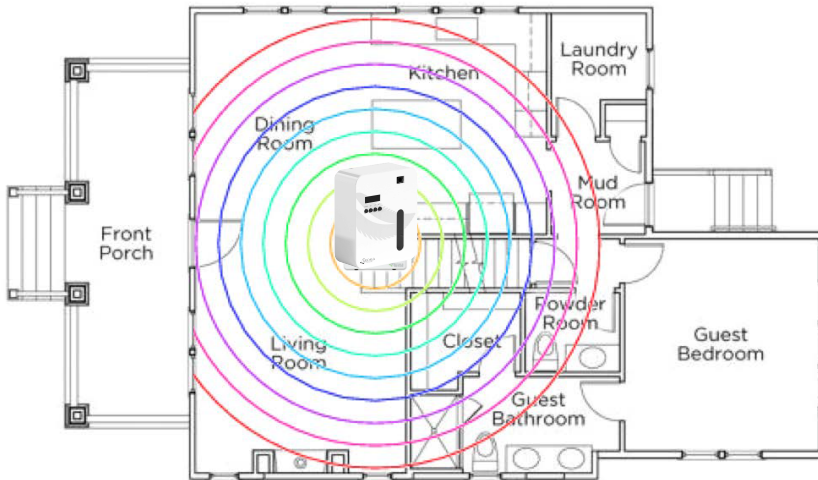

The best location is in a centralized location with good airflow around the unit.



MODEL - SCENT MACHINE 101 SMART

HELP: care@aromaretail.com 702-780-7370